

THE SIXIÈME CLASS AND SECONDARY STUDIES AT LYCÉE CHARLES DE GAULLE

School year 2020-2021



ÉTABLISSEMENT
EN GESTION DIRECTE



aefe

Agence pour
l'enseignement français
à l'étranger

TWO POSSIBLE PATHS

Plurilingue Section

English International
Section



THE PLURILINGUE SECTION

6ÈME

- **LV1 English = 4h**
- **LV1 b = 3h**
German or Spanish
or Italian or Russian

5ÈME

- **LV1 English = 4h**
- **LV1 b = 3h**
German or Spanish
or Italian or Russian

4ÈME

- Same compulsory languages
- Optional addition of **Latin** or **Greek** or **LV1b complement** or **LV3** (Spanish, German or Arabic)
- Option to continue to the **British Section** after 4^{ème}

THE PLURILINGUE SECTION

3ÈME

- **LV1 English = 4h**
- **LV1 b = 3h**
German or Spanish
or Italian or Russian
- Optional: **Latin** or **Greek** or
LV 1b complement or **LV3**

EXAM

Diplôme national du brevet



WHO IS THE INTERNATIONAL SECTION FOR?

- Fluent/bilingual students
- Students with a real love of English Literature
- Students who are ready for the challenge of extra hours / subjects
- NOT for students who are looking to improve their spoken / written English.



THE INTERNATIONAL SECTION

6ÈME

- **LV English language and literature** = 6h + 1h support
- **History & Geography in English** (DNL) = 2h (+2h in French)

5ÈME

- Same English schedule (except support) and DNL
- **LV2** = 3h German or Spanish

4ÈME

- Same language schedule
- Optional addition of **Latin** or **Greek** (2h)

THE INTERNATIONAL SECTION

3ÈME

Same language schedule

EXAM

- Same English schedule (except support) and DNL
- **DNB-I** (DNB + two oral tests in English language and History in English)



COMPARATIVE PLURILINGUE SECTION AND INTERNATIONAL SECTION

| CLASS | PLURILINGUE SECTION | INTERNATIONAL SECTION |
|------------------|--|--|
| 6 ^{ème} | English = 4h LV1 b (German or Spanish or Italian or Russian) = 3h | English = 6h + 1h support Non linguistic subject (History & Geo. in English) = 2h |
| 5 ^{ème} | English = 4h LV1 b (German or Spanish or Italian or Russian) = 3h | English = 6h Non linguistic subject (History & Geo. in English) = 2h LV2 (German or Spanish) = 3h |
| 4 ^{ème} | English = 4h LV1 b (German or Spanish or Italian or Russian) = 3h <i>Optional addition of 1 subject: LV1b complement = 2h or Classics (Latin or Greek) = 2h ou LV3 (German, Spanish or Arabic) = 2h</i> Option to join the British Section (via exam) | English = 6h Non linguistic subject (History & Geo. in English) = 2h LV2 (German or Spanish) = 3h <i>Optional addition of Latin or Greek = 2h</i> |
| 3 ^{ème} | Same language schedule as in 4 ^{ème} | Same language schedule as in 4 ^{ème} |
| Examen | DNB | DNB-I |

ENTRY INTO 6^{ÈME}

INTERNATIONAL SECTION

Entry to the International Section is decided via a test. Last year due to Covid, assessments were conducted virtually. It is likely such testing will be in place for September 2021 applicants. Methods of assessment are in discussion and will be communicated shortly.

PLURILINGUE SECTION

Testing is used to determine into which level English group pupils will be placed. Once again, methods of assessment are in discussion and will be communicated shortly.

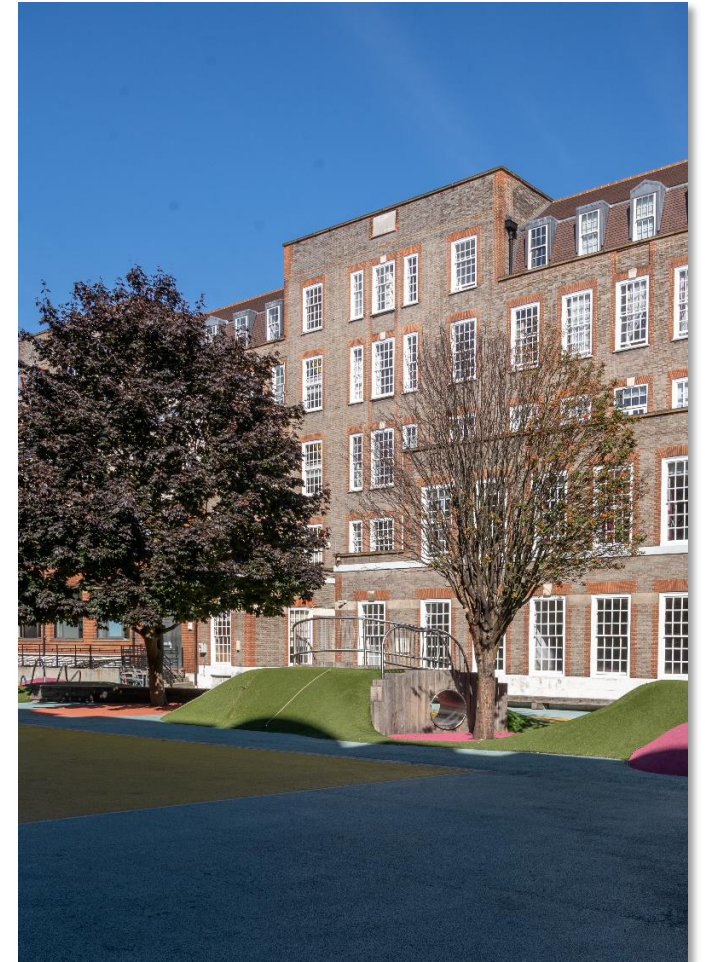

PASSERELLE / BRIDGE 3^{ÈME} / 2^{NDE}

- Students from SP can apply to enter the SI: they can do the IGCSE in English Language. Some may also take the IGCSE in English Literature depending on their ability to catch up on the 3^{ème} SI programme.
- Students can elect to leave the International Section at the end of 3^{ème}.



THE LYCÉE

THE SECONDE GÉNÉRALE

- Option to attend OIB (*option internationale du baccalauréat*, on demand for pupils coming from the International Section; by examination for other pupils).
- Same language choices as in *collège* (please note all languages are subject to continuous learning: no beginners in *seconde* class).
- IGCSE Language / Literature - These are compulsory for most International Section pupils (except for those who joined SI in 3^{ème} who may only take the English Language IGCSE) and comprise 4 written exams and 1 oral exam in May of 2^{nde}. It is a 2-year course and students start to prepare in 3^{ème}.

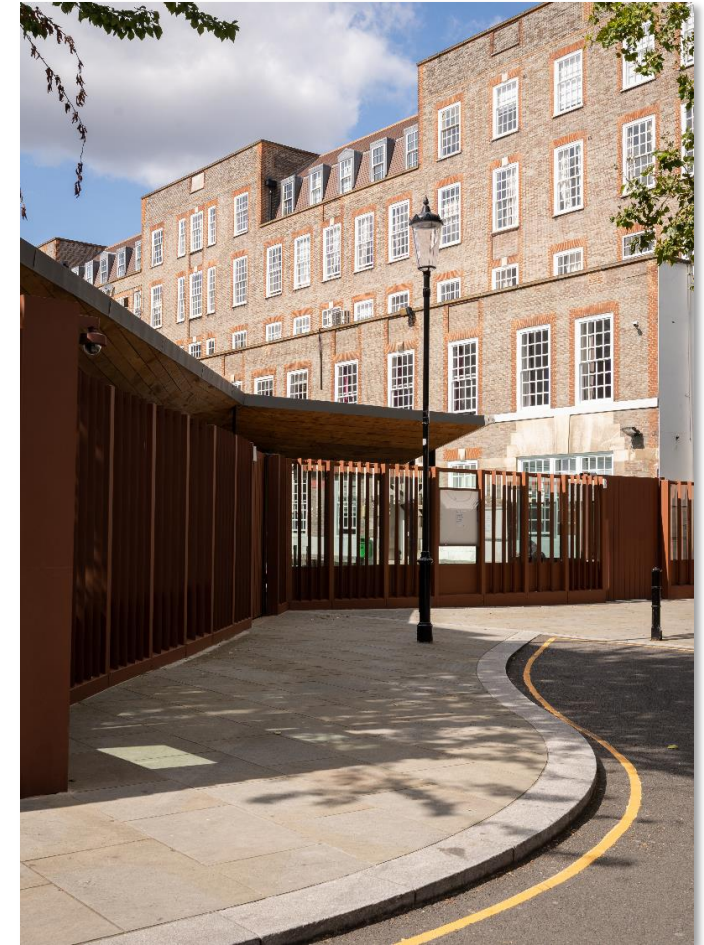

THE LYCÉE

FROM PREMIÈRE

- Reform of the Baccalaureate
- Optional bridge from *seconde générale* to the British Section (A levels), conditional (minimum grade B at English language IGCSE + test)
- OIB English and H/G: part of the « *tronc commun* » of subjects but with a higher coefficient (worth almost as much as the « *spécialité* » subjects)





THANK YOU FOR YOUR ATTENTION

