

# THE SIXIÈME CLASS AND SECONDARY STUDIES AT LYCÉE CHARLES DE GAULLE



## TWO POSSIBLE PATHS

Plurilingue Section

English International  
Section



# THE PLURILINGUE SECTION

## 6ÈME

- **LV1 English = 4h**
- **LV1 b = 3h**  
German or Spanish  
or Italian or Russian

## 5ÈME

- **LV1 English = 4h**
- **LV1 b = 3h**  
German or Spanish  
or Italian or Russian

## 4ÈME

- Same compulsory languages
- Optional addition of **Latin** or **Greek** or **LV1b complement** or **LV3** (Spanish, German or Arabic)
- Option (test-based) to move to the **British Section** after 4ème

# THE PLURILINGUE SECTION

## 3ÈME

- **LV1 English = 4h**
- **LV1 b = 3h**  
German or Spanish  
or Italian or Russian
- Optional: **Latin** or **Greek** or  
**LV 1b complément** or **LV3**

## EXAM

**Diplôme national du brevet**

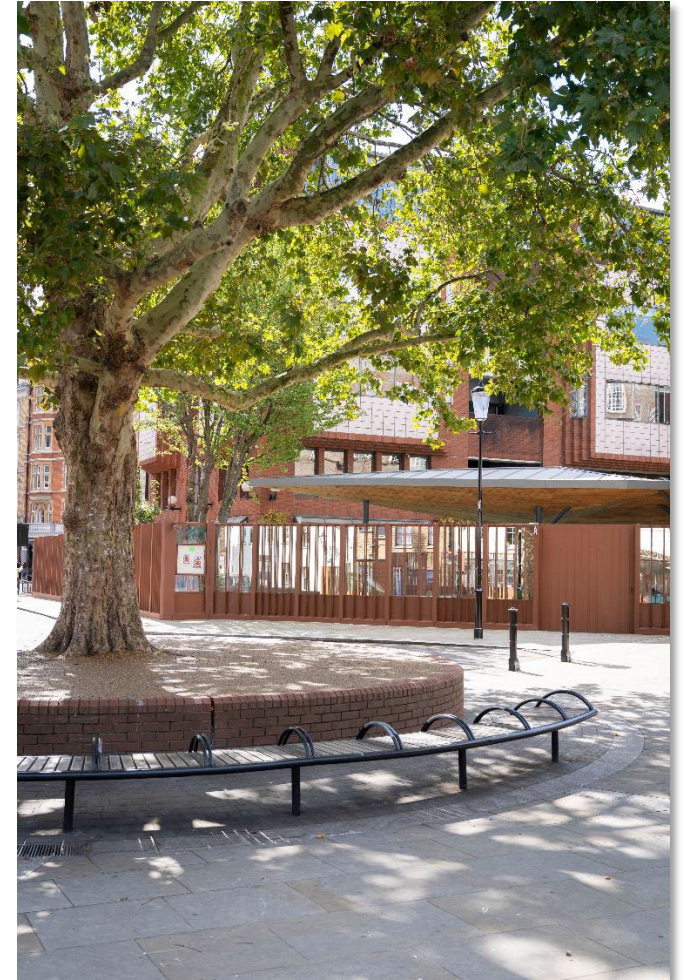

## WHO IS THE INTERNATIONAL SECTION FOR?

- Fluent / bilingual students
- Students with a real love of English Literature
- Students who are ready for the challenge of extra hours / subjects
- NOT for students who are looking to improve their spoken / written English.



# THE INTERNATIONAL SECTION

## 6ÈME

- **LV English language and literature** = 6h + 1h support
- **History & Geography in English** (DNL) = 2h (+2h in French)

## 5ÈME

- Same English schedule (except support) and DNL
- **LV2** = 3h German or Spanish

## 4ÈME

- Same language schedule
- Optional addition of **Latin** or **Greek** (2h)
- Option (test-based) to move to the **British Section** after 4ème

# THE INTERNATIONAL SECTION

## 3ÈME

Same language schedule

Start of the 2-year IGCSE English literature and language programme

## EXAM

- Same English schedule (except support) and DNL
- **DNB-I** (DNB + two oral tests in English language and History in English)



# COMPARATIVE PLURILINGUE SECTION AND INTERNATIONAL SECTION

CLASS	PLURILINGUE SECTION	INTERNATIONAL SECTION
6 <sup>ème</sup>	English = 4h LV1 b (German or Spanish or Italian or Russian) = 3h	English = 6h + 1h support Non linguistic subject (History & Geo. in English) = 2h
5 <sup>ème</sup>	English = 4h LV1 b (German or Spanish or Italian or Russian) ) = 3h	English = 6h Non linguistic subject (History & Geo. in English) = 2h LV2 (German or Spanish) = 3h
4 <sup>ème</sup>	English = 4h LV1 b (German or Spanish or Italian or Russian) ) = 3h <i>Optional addition of 1 subject: LV1b complément = 2h or Classics (Latin or Greek) = 2h ou LV3 (German, Spanish or Arabic) = 2h</i> Option to join the British Section (via exam)	English = 6h Non linguistic subject (History & Geo. in English) = 2h LV2 (German or Spanish) = 3h Optional addition of Latin or Greek = 2h Option (test-based) to join the British Section
3 <sup>ème</sup>	Same language schedule as in 4 <sup>ème</sup>	Same language schedule as in 4 <sup>ème</sup>
Examen	DNB	DNB-I



ENSEIGNEMENTS OBLIGATOIRES	HORAIRES HEBDOMADAIRES							
	Sixième plurilingue	Sixième internationale	Cinquième plurilingue	Cinquième internationale	Quatrième plurilingue	Quatrième internationale	Troisième plurilingue	Troisième internationale
Éducation physique et sportive	4 heures		3 heures		3 heures		3 heures	
Arts plastiques + éducation musicale	1 heure	1 heure	1 heure		1 heure		1 heure	
Français	4,5 heures		4,5 heures		4,5 heures	4,5 heures	5 heures	
Histoire - Géographie Enseignement moral et civique	3 heures	2 heures en français + 2heures en anglais	3 heures	2 heures en français + 2 heures en anglais	3,5 heures	2 heures en français + 2 heures en anglais	3,5 heures	2 heures en français + 2 heures en anglais
Langue vivante 1 (anglais)	4 heures	6 heures	4 heures	6 heures	4 heures	6 heures	4 heures	6 heures
Langue vivante 2	3 heures		3 heures		3 heures		3 heures	
Mathématiques	4,5 heures		3,5 heures	3,5 heures	3,5 heures		3,5 heures	
Sciences	2 heures							
SVT			1,5 heure		1,5 heure	1,5 heure	1,5 heure	
Physique-chimie			1,5 heure		1,5 heure	1,5 heure	2 heures	
Technologie							1 heure	
EPI			0.5 heure (initiation Latin grec)					
<b>Total</b>	<b>26 heures</b>	<b>26 heures</b>	<b>25,5 heures</b>	<b>28,5 heures</b>	<b>25,5 heures</b>	<b>28 heures</b>		
ENSEIGNEMENTS FACULTATIFS	HORAIRES HEBDOMADAIRES							
Langues et cultures européennes					2 heures		2 heures	
Langues et cultures de l'Antiquité					2 heures	2 heures	2 heures	2 heures
Langues de complément					2 heures		2 heures	
Chant choral	72 heures annuelles, dont au moins une heure hebdomadaire							
Orchestre	72 heures annuelles, dont au moins une heure hebdomadaire							
Français Langue scolarisation	Au moins une heure hebdomadaire							

## ENTRY INTO 6<sup>ÈME</sup>

### INTERNATIONAL SECTION

Entry to the International Section is determined via a test.

### PLURILINGUE SECTION

Plurilingue classes are ability-streamed for English. For pupils already in one of the Lycée's primary schools or partner schools, English teachers provide the Lycée with a recommended level for each pupil. External pupils will be assessed in September.





## EXAMINATION PROCEDURES FOR ENTRY TO THE INTERNATIONAL SECTION

- London-based pupils will come to our South Kensington site on Saturday 26<sup>th</sup> April for a test.
- Pupils living abroad will sit the test at their school during the week beginning Monday 28<sup>th</sup> April.
- We will use an 11+ test from the external company GL Assessment.
- The test is a written, paper-based test. Pupils will read two short texts (each text is roughly one A4 printed side in length) and then will answer about 60 multiple-choice questions.
- The questions are designed to test pupils on their reading comprehension skills, vocabulary, punctuation, spelling and grammar.
- The tests are of an advanced/fluent level, so please bear this in mind when submitting an application
- Example texts and questions can be found [here](#)



# WEIGHT OF THE TEST

Répartition des coefficients

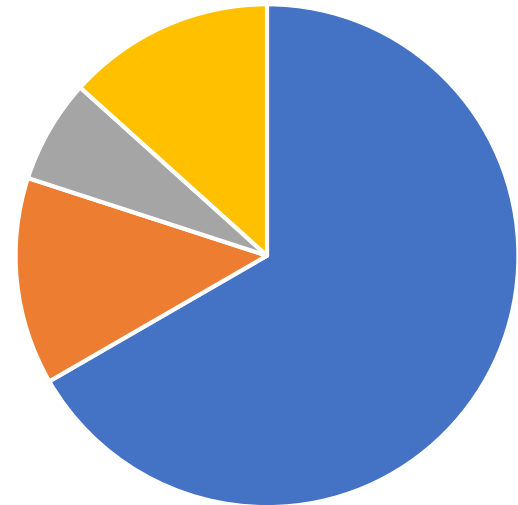

■ TEST ■ Anglais écrit ■ Anglais oral ■ Compétences transversales

## **PASSERELLE / BRIDGE 3<sup>ÈME</sup> / 2<sup>NDE</sup>**

- Students from SP can apply to enter the SI: they can do the IGCSE in English Language.
- Students can elect to leave the International Section at the end of 3<sup>ème</sup>.



# THE LYCÉE

## THE SECONDE GÉNÉRALE

- Students can elect to leave the International Section at the end of 2<sup>nde</sup>.
- Same language choices as in collège (please note all languages are subject to continuous learning: no beginners in seconde class).

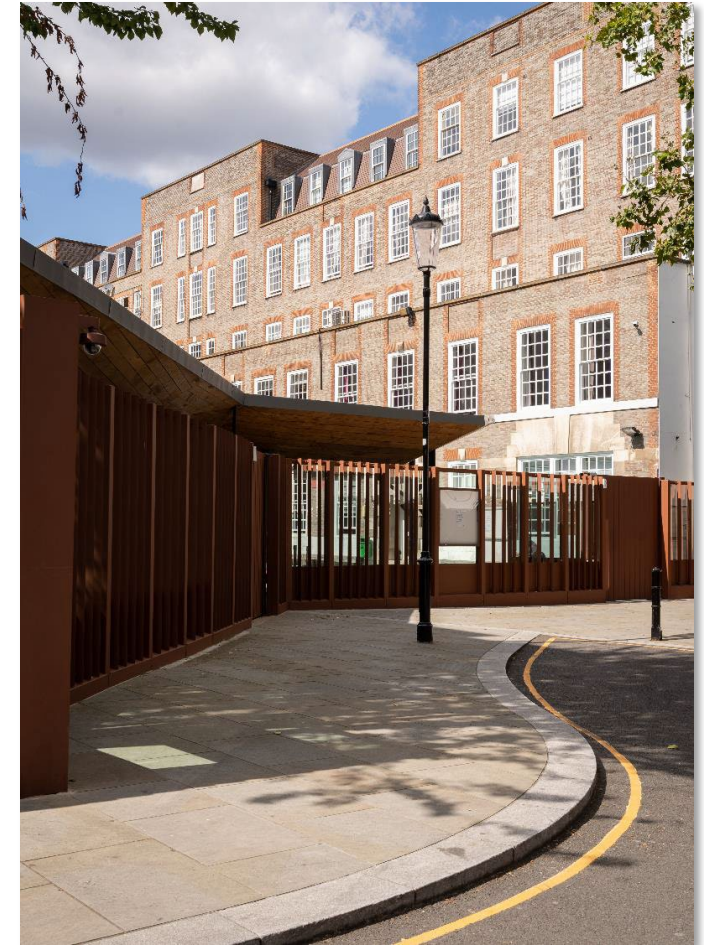

# THE LYCÉE

## FROM PREMIÈRE PUPILS HAVE THE OPTION TO STUDY:

The French Bac

The International French Bac (bilingual or trilingual)

- Students from 2nde SP can apply to enter the B.F.I (test based)
- A'levels (British Section)
- Optional bridge from seconde générale to the British Section (A levels), conditional (minimum grade B at English language IGCSE + test)





THANK YOU FOR YOUR ATTENTION

